

Brickpoint
PROPERTIES, INC.



OFFICE SPACE AVAILABLE | PRIME LOCATION

TWO MAIN STREET

STONEHAM, MA

Two Main Street features a two-story atrium lobby, high quality office space and an excellent location directly off Route 28 adjacent to the Route 128/Interstate 95 entrance ramp and less than one mile (one exit) from the Route 128/Interstate 93 interchange in Woburn.

The building also provides Route 128 visibility and tremendous signage potential on Route 28. It's easily accessible to a wide variety of amenities including retail establishments, restaurants, hotels, and appealing residential communities.

AVAILABLE SPACE

Suite 200 — 5,820 SF*

Suite 350 — 3,965 SF*

**Sub-dividable to 1,500 SF*

For leasing information, contact:

Peter Abren
pabren@brickpoint.com
781-979-9723 direct
978-423-1447 cell



BUILDING SPECIFICATIONS

Zoning	Highway Business
Site Area	Approx. 2.33 acres
Building Area	Approx. 50,000
Available Sq Ft	Approx. 9,785
Year Built	Early 1980
Building Structure	Steel Frame & Masonry
Parking	Approx. 3.4 spaces / 1,000 SF
Telecommunications	Verizon Fiber Optic
Roof	Rubber Membrane
Floors	3 Stories
Power	800 amp, 120/208 v
HVAC	Gas Heat / Electric Air Cond.
Utilities	Metered Separately
Elevator	One, US Passenger, 2,150 cap.

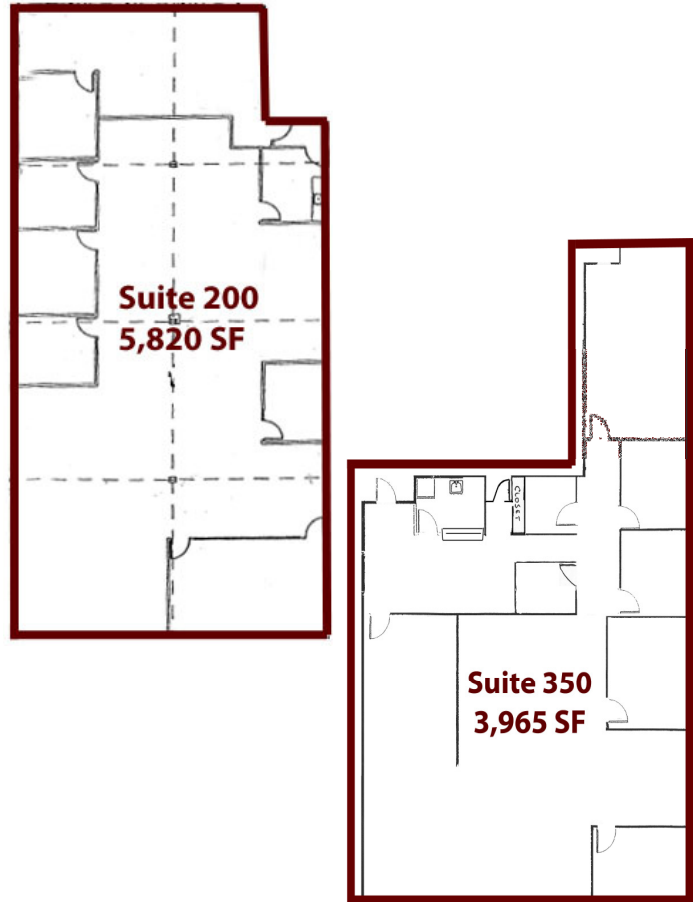

TWO MAIN STREET, STONEHAM MA

